

# SHIMMERS™

## SHIMMERS Bearing Strips

Used for placing and leveling precast panels, tilt slabs and other architectural or structural components.

**SHIMMERS** bearing strips are designed to be placed between concrete floor slabs and a supporting wall or beam. The smooth surface allows for movement of precast floor slabs and helps them easily slide into their final position.

- Strips are easily applied and lay flat
- Smooth surface allows precast plank to slide easily



Part Number	Size	Box QTY
ST0250248	2" x 48" x 1/4"	72
ST0130248	2" x 48" x 1/8"	144
ST0250348	3" x 48" x 1/4"	48
ST0130348	3" x 48" x 1/8"	96
ST0250448	4" x 48" x 1/4"	36
ST0130448	4" x 48" x 1/8"	72

**MADE IN THE USA**

## SHIMMERS Horseshoe Shims

- Economical
- Save time, money and labor.
- Excellent compressive strength.
- Available in a wide variety of sizes.

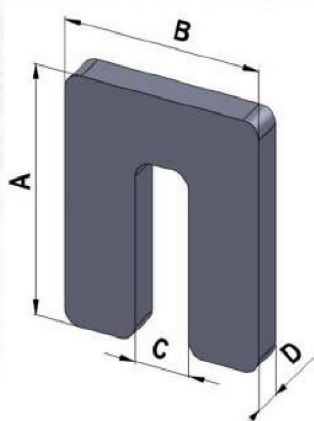

	Part Number	Length A	Width B	Slot C	Thickness D	Color	Box QTY
20 Series	SH0060203	3"	2-5/16"	13/16	1/16"	Blue	1000
	SH0130203				1/8"	Red	1000
	SHC0250203				1/4"	Black	500
	SH0380203				3/8" SOLID	Black	150
	SH0500203				1/2" SOLID	Black	150
50 Series	SH0060304	4"	3"	13/16"	1/16"	Blue	500
	SH0130304				1/8"	Red	500
	SHC0250304				1/4"	Black	250
	SH0380304				3/8" SOLID	Black	150
	SH0500304				1/2" SOLID	Black	150

**Other Sizes as well as custom design available.**

Please inquire @ [info@jvi-inc.com](mailto:info@jvi-inc.com) regarding product origin



**Your Connection Connection**

7131 North Ridgeway Avenue • Lincolnwood, IL 60712 USA  
847/675-1560 • Fax 847/675-0083 • 1-800-742-8127 • <http://www.jvi-inc.com>





# SHIMMERS™

## SHIMMERS Shim-Packs

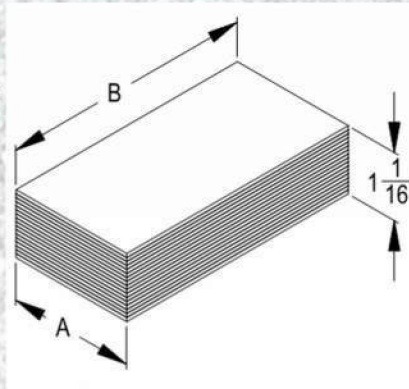

Part Number	Thickness	A	B	Box QTY
SP1060202	1-1/16"	2"	2"	50
SP1060303		3"	3"	50
SP1060404		4"	4"	50
SP1060406		4"	6"	50
SP1060505		5"	5"	25
SP1060606		6"	6"	20
SP1060608		6"	8"	20
SP1060610		6"	10"	20

**MADE IN THE USA**

- Pre-assembled packages of shims designed for precise placing of large load bearing precast units.
- Eliminates correction of elastomeric drift.
- Can be compressed sufficiently at post tensioning to allow load transfer to the grout.
- 17 pieces; 1/16" thick, HEAT-SEALED together on adjacent sides.
- Peel off shims in 1/16" Increments to obtain the correct height adjustment.

## SHIMMERS Multi-Packs



Part Number	Thickness	A	B	Box QTY
SM1060404	1-1/16"	4"	4"	50
SM1060406		4"	6"	30

Please inquire @ [info@jvi-inc.com](mailto:info@jvi-inc.com) regarding product origin

- 1 1/16" Thick 4" x 4" or 4 x 6" Multi-Pack contains (1) 1/16", (2) 1/8" & (3) 1/4" shims rubber-banded together for easy height adjustment.
- Color Coded by Thickness
- Each Shim has no-slip serrations.
- Pre-assembled packages of shims designed for precise placing of large load bearing precast units.
- Eliminates correction of elastomeric drift.
- Can be compressed sufficiently at post tensioning to allow load transfer to the grout.



**Your Connection Connection**

7131 North Ridgeway Avenue • Lincolnwood, IL 60712 USA  
847/675-1560 • Fax 847/675-0083 • 1-800-742-8127 • <http://www.jvi-inc.com>





# SHIMMERS<sup>TM</sup>

## SHIMMERS Shim Strips

- Assures accurate placing and leveling of precast panels, tilt-up walls, structural and architectural components.
- Has excellent stability, eliminates rust, stained concrete, etc.
- Less expensive and more versatile than steel.
- Available in convenient thicknesses, lengths and widths which permit precise leveling and alignment.
- Will not rust, rot, stain or leach concrete.

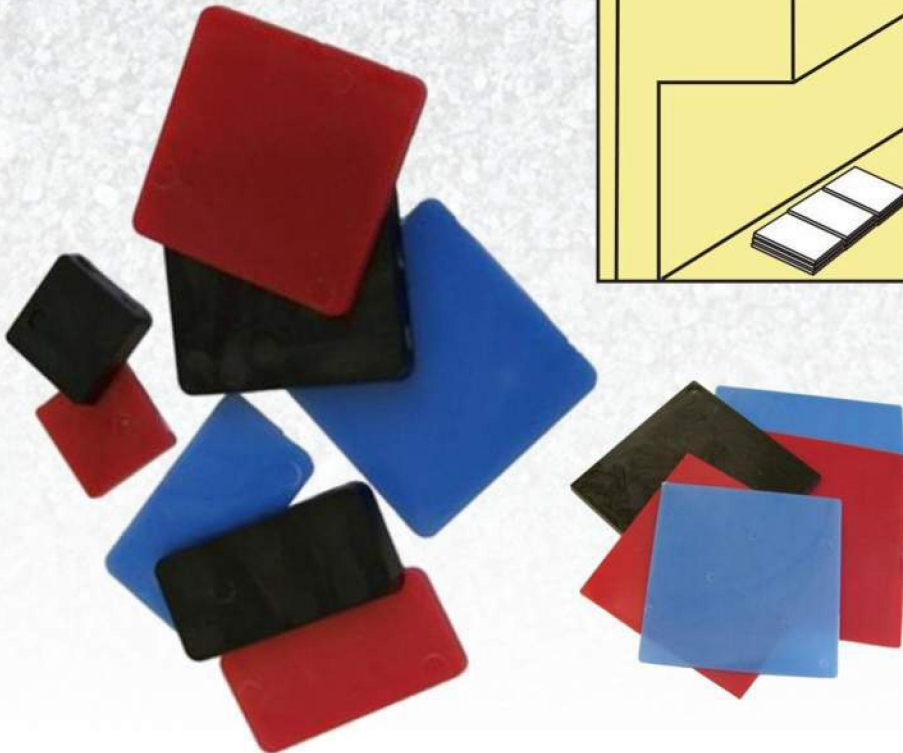
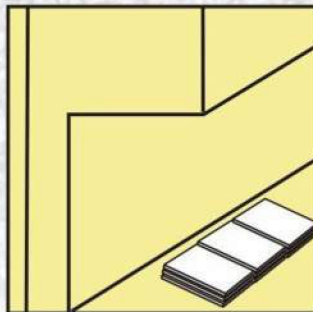
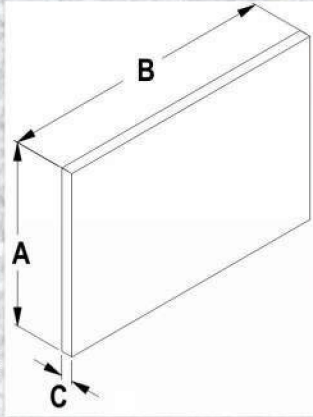

Part Number	Shim Dimensions			Box QTY
	A	B	C	
SS0060202	2"	2"	1/16"	1000
SS0130202			1/8"	1000
SS0250202			1/4"	1000
SS0380202			3/8"	500
SS0500202			1/2"	250
SS0060303	3"	3"	1/16"	1000
SS0130303			1/8"	1000
SS0250303			1/4"	500
SS0500303			1/2"	250
SS0060204	4"	2"	1/16"	1000
SS0130204			1/8"	1000
SS0250204			1/4"	500
SS0060404	4"	4"	1/16"	500
SS0130404			1/8"	500
SS0250404			1/4"	250
SS0500404			1/2"	125
SS0060406	4"	6"	1/16"	500
SS0130406			1/8"	250
SS0250406			1/4"	125
SS0060408	4"	8"	1/16"	250
SS0130408			1/8"	250
SS0250408			1/4"	125
SS0060505	5"	5"	1/16"	500
SS0130505			1/8"	250
SS0250505			1/4"	125
SS0060206	6"	2"	1/16"	500
SS0130206			1/8"	500
SS0250206			1/4"	250
SS0060606	6"	6"	1/16"	250
SS0130606			1/8"	125
SS0250606			1/4"	125
SS0060608	6"	8"	1/16"	250
SS0130608			1/8"	160
SS0250608			1/4"	80

Other Sizes Available

**MADE IN THE USA**



**Your Connection Connection**

7131 North Ridgeway Avenue • Lincolnwood, IL 60712 USA  
847/675-1560 • Fax 847/675-0083 • 1-800-742-8127 • <http://www.jvi-inc.com>





# SHIMMERS™

Available as shim strips, shim packs, bearing strips and horseshoe shims, **SHIMMERS** are perfect for leveling and accurate placement of precast and prestressed concrete walls, floors, and architectural and structural components.



Molded from high-impact polystyrene (HIPS), **SHIMMERS** are excellent in compressive strength, have superior surface contact characteristics and are fabricated as **SOLID** plastic shims with no voids.

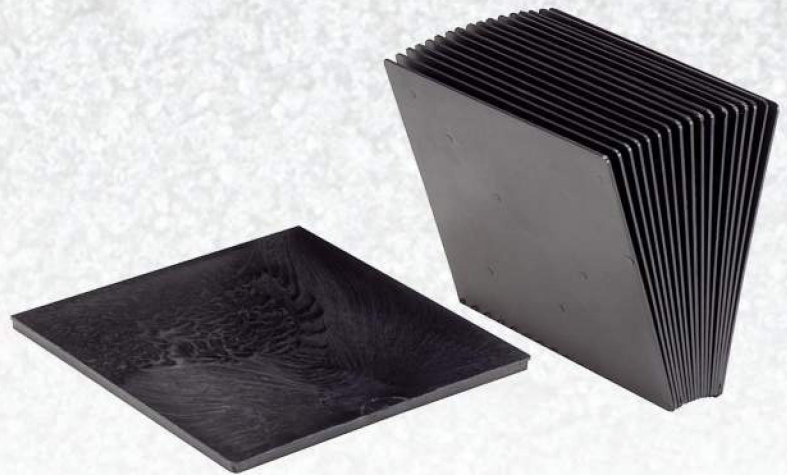
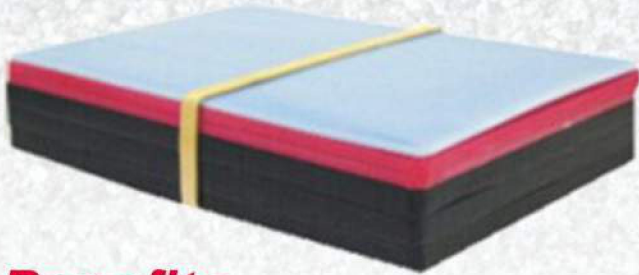

## Benefits

- Economical
- Will NOT rust, stain or leach concrete
- Available in precise thicknesses and lengths
- Compressive Strength of 10,000 psi with no fracture
- Unaffected by liquids, chemicals, alkalis and micro-organisms.



**Your Connection Connection**

7131 North Ridgeway Avenue • Lincolnwood, IL 60712 USA  
847/675-1560 • Fax 847/675-0083 • 1-800-742-8127 • <http://www.jvi-inc.com>





# SHIMMERS<sup>TM</sup>

## Adjustable Horseshoe Shim Packs

- Adjustable Heights
- Adjustable Lengths
- Available in 3 sizes
- Time and Labor Savings
- Conveniently Packaged
- Easy to Install

Stack shim allows up to 5 length adjustments—up to 16 thickness adjustments. 3-½" and 4-¼", and 4¾" lengths. 16 shims are heat sealed into 1" stacks. Will not rust, stain or leach.

Part Number	Length A	Width B	Slot C
SHA10001031A1	3"	1-15/16"	5/8"
SHA10001031B1	3 1/2"		
SHA10001041A1	4 1/4"		
SHA10001041B1	4 3/4"		

Compressive strength of 10,000 psi

Econ-O-Shims are molded from an engineered plastic which combines excellent compressive strength and good load bearing surface contact.

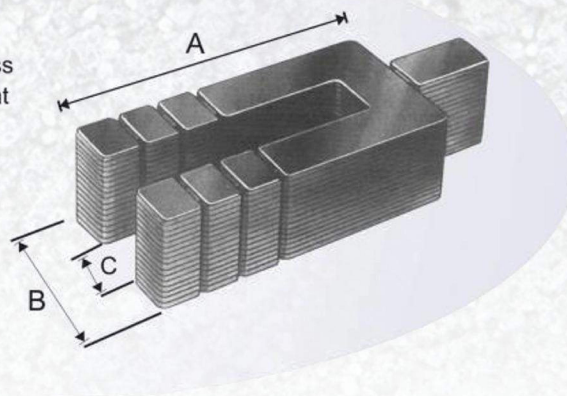

### Your Connection Connection

7131 North Ridgeway Avenue • Lincolnwood, IL 60712 USA  
847/675-1560 • Fax 847/675-0083 • 1-800-742-8127 • <http://www.jvi-inc.com>